

## W0.8-I-19.5

Adapter system mount Ø 19.5 mm to internal RMS thread



### FEATURES

Adapter internal RMS thread (Whitworth thread W 0,8" × 1/36") to system mount Ø 19.5 mm, e.g. for microscope lenses

- System Mount Ø 19.5 mm
- RMS thread, internal
- Clear aperture Ø 15 mm

## TECHNICAL DATA

W0.8-I-19.5

Order Code		W0.8-I-19.5
Adapter	Internal thread	System mount
	W 0.8" × 1/36	Ø 19.5 mm
		Steel ring
Clear aperture	Ø 15 mm	
Material	Black anodized aluminum / steel	
Weight	6 g	

Dimensions (for a complete dimensional drawing please refer to the downloads section)

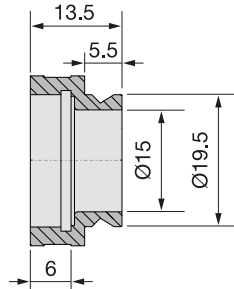

## RELATED PRODUCTS

### ADAPTERS FOR SYSTEM MOUNT Ø 19.5MM

for incorporation into the multicube™ system

### ADAPTERS FOR FIBER OPTICS

Adapters to use with fiber collimators and with the multicube™ system.

### ATTACHMENT OPTICS SERIES 13

to attach in the front of collimators with system mount Ø19.5 mm

This is a printout of the page [https://sukhamburg.com/products/details/W0\\_8-I-19\\_5](https://sukhamburg.com/products/details/W0_8-I-19_5) from 5/5/2024

## CONTACT

For more information please contact:

Schäfter + Kirchhoff GmbH

Kieler Str. 212

22525 Hamburg

Germany

Tel: +49 40 85 39 97-0

Fax: +49 40 85 39 97-79

[info@sukhamburg.de](mailto:info@sukhamburg.de)

[www.sukhamburg.com](http://www.sukhamburg.com)

## LEGAL NOTICE

**Copyright 2020 Schäfter+Kirchhoff GmbH. All rights reserved.**

Text, image, graphic, sound, video and animation files and their arrangement on Schäfter+Kirchhoff GmbH webpages are protected by copyright and other protective laws. The content may not be copied for commercial use or reproduced, modified or used on other websites. [\[more\]](#)