

SM1-IG-AC19.5

Adapter SM1 thread internal to system mount Ø 19.5 mm, 3°



FEATURES

With the adapter SM1-IG-AC19.5 you can adapt mounted optics with SM1 external thread to, e.g. fiber collimators of series [60FC-L](#) or [60FC-T](#) with an outer diameter Ø 25 mm. The optical axis is inclined by 3 °.

- SM1 thread, internal, inclined 3°
- System mount Ø 19.5 mm
- Clear aperture

TECHNICAL DATA

SM1-IG-AC19.5

Order Code		SM1-IG-AC19.5
Adapter	Internal thread	System mount
	SM-1	Ø 19.5 mm
		Steel ring
		Coupling axis inclined 3°
Clear aperture	Ø 12 mm	
Material	Black anodized aluminum	
Weight	4 g	

Dimensions (for a complete dimensional drawing please refer to the downloads section)

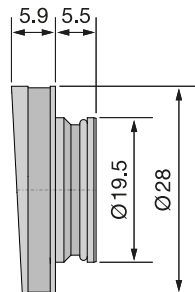

DOWNLOADS



[981120100100.pdf \(Dimensional drawing\)](#)

RELATED PRODUCTS

ADAPTERS FOR FIBER OPTICS

Adapters to use with fiber collimators and with the multicube™ system.

ATTACHMENT OPTICS SERIES 13

to attach in the front of collimators with system mount Ø19.5 mm

ADAPTERS FOR SYSTEM MOUNT Ø 19.5MM

for incorporation into the multicube™ system

This is a printout of the page https://sukhamburg.com/products/details/SM1-IG-AC19_5 from 5/7/2024

CONTACT

For more information please contact:

Schäfter + Kirchhoff GmbH

Kieler Str. 212

22525 Hamburg

Germany

Tel: +49 40 85 39 97-0

Fax: +49 40 85 39 97-79

info@sukhamburg.de

www.sukhamburg.com

LEGAL NOTICE

Copyright 2020 Schäfter+Kirchhoff GmbH. All rights reserved.

Text, image, graphic, sound, video and animation files and their arrangement on Schäfter+Kirchhoff GmbH webpages are protected by copyright and other protective laws. The content may not be copied for commercial use or reproduced, modified or used on other websites. [\[more\]](#)