

## Half-wave plate, low-order 5WP-2-679L-S

allows polarization rotation of linearly polarized radiation of 679 nm



### FEATURES

The retardation optics of type 5WP-2-679L-S is a half-wave plate that allows the polarization rotation of linearly polarized radiation of 679 nm.

- Attachment optics with system mount Ø 8 mm for fiber collimators type [60FC](#) with outer diameter Ø 12 mm
- Low-order half-wave retardation optics with an 1.5° inclined mounting in order to avoid direct back-reflections
- Center wavelength: 679 nm
- Free rotation for best adjustment with positional locking using radially arranged screws.
- Short version
- Adjustable using Schäfter+Kirchhoff Polarization Analyzer series [SK010PA](#).
- For collimating focal lengths  $f > 25$  mm  
Schäfter+Kirchhoff offers fiber collimators of type [60FC-Q](#) with integrated retardation optics.

## TECHNICAL DATA

Half-wave plate, low-order 5WP-2-679L-S

Order Code	5WP-2-679L-S
Center wavelength	679 nm
Retardation	$\lambda/2$
Order	low-order
AR coating	yes
Material	Quartz
Clear aperture	5 mm
Inclined mounting of retardation optics	1.5°

System mount	Ø 8 mm
Front fitting	-
Housing material	Nickel silver
Weight	5 g
Dimensions (for a complete dimensional drawing please refer to the downloads section)	

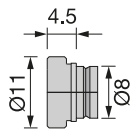

## DOWNLOADS



[921120280500.pdf \(Dimensional drawing\)](#)

## ACCESSORIES

**POLARIZATION ANALYZER SK010PA** Measurement tool for coupling into polarization-maintaining fiber cables

**9D-12** Screwdriver WS 1.2

## RELATED PRODUCTS

**HALF-WAVE PLATES 5WP-2 (LOW-ORDER)** allows polarization rotation of linearly polarized radiation

**FIBER COLLIMATOR SERIES 60FC** for collimating radiation exiting an optical fiber or as an incoupler

**FIBER COLLIMATOR  
60FC-Q**

Fiber Collimator for collimating large beam diameters  
and with integrated quarter-wave plate

This is a printout of the page <https://sukhamburg.com/products/details/5WP-2-679L-S> from 5/14/2024

## CONTACT

For more information please contact:

Schäfter + Kirchhoff GmbH

Kieler Str. 212

22525 Hamburg

Germany

Tel: +49 40 85 39 97-0

Fax: +49 40 85 39 97-79

[info@sukhamburg.de](mailto:info@sukhamburg.de)

[www.sukhamburg.com](http://www.sukhamburg.com)

## LEGAL NOTICE

**Copyright 2020 Schäfter+Kirchhoff GmbH. All rights reserved.**

Text, image, graphic, sound, video and animation files and their arrangement on Schäfter+Kirchhoff GmbH webpages are protected by copyright and other protective laws. The content may not be copied for commercial use or reproduced, modified or used on other websites. [\[more\]](#)