

## 5PF-P-600-L

Dichroic polarization filter (long version)



### FEATURES

Polarization filter with system mount Ø 8 mm for attaching to [60FC](#) Fiber Collimators (with outer diameter Ø 12 mm).

The filter transmits only the linear polarized component of the radiation.

- Dichroic polarization filter. The filter is laminated to a glass substrate with an 1.5° inclined mounting in order to avoid direct back-reflections
- Polarization extinction ratio 10.000:1
- Surface deviation <  $\lambda/4$
- Clear aperture: 5 mm
- System mount: Ø 8 mm
- AR Coating: 600 - 825 nm
- Long-form housing with system mount Ø 8 mm for adding additional attachment optics

## TECHNICAL DATA

5PF-P-600-L

Order code	5PF-P-600-L
Type	Dichroic polarization filter
Wavelength range	600 - 850 nm
Extinction	10.000:1
Transmission	> 84 - 93 %
AR coating	600 - 825 nm (residual reflectivity < 1.5 %)
Surface deviation	< $\lambda/4$
Clear aperture	Ø 5 mm
Inclined mount	1.5°
System mount	Ø 8 mm

Front fitting	System mount Ø 8 mm
Housing material	Nickel silver
Weight	5 g
Dimensions (for a complete dimensional drawing please refer to the downloads section)	

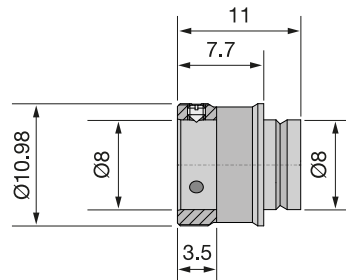

## DOWNLOADS



[921120280200.pdf \(Dimensional drawing\)](#).

## ACCESSORIES

### POLARIZATION ANALYZER SK010PA

Measurement tool for coupling into polarization-maintaining fiber cables

## RELATED PRODUCTS

### POLARIZATION FILTERS 5PF

for attaching to 60FC Fiber Collimators

This is a printout of the page <https://sukhamburg.com/products/details/5PF-P-600-L> from 5/4/2024

## CONTACT

For more information please contact:

**Schäfter + Kirchhoff GmbH**

**Kieler Str. 212**

**22525 Hamburg**

**Germany**

**Tel: +49 40 85 39 97-0**

**Fax: +49 40 85 39 97-79**

**[info@sukhamburg.de](mailto:info@sukhamburg.de)**

**[www.sukhamburg.com](http://www.sukhamburg.com)**

## LEGAL NOTICE

**Copyright 2020 Schäfter+Kirchhoff GmbH. All rights reserved.**

Text, image, graphic, sound, video and animation files and their arrangement on Schäfter+Kirchhoff GmbH webpages are protected by copyright and other protective laws. The content may not be copied for commercial use or reproduced, modified or used on other websites. [\[more\]](#)