

## 48WP-2-780-1-767, dichroic wave plate, multiple-order

allows polarization rotation of linearly polarized radiation of 780 nm, while 767 nm is unaffected



### FEATURES

The retardation optics type 48WP-2-780-1-767 is a half-wave plate that allows the polarization rotation of linearly polarized radiation of the wavelength 780 nm, while the state of polarization of 767 nm is unaffected. It has a rotary mount and is designed to be integrated into the [multicube](#) system.

- Quartz plate, multiple order
- Retardation  $\lambda/2$  for the wavelength 780 nm
- Retardation  $\lambda/1$  for the wavelength 767 nm (polarization is not affected)
- Clear aperture 5 mm
- In adjustable mount with self-locking tubular axis (0 - 360°)
- Rotation around axis that is inclined 2° with respect to the optical axis. This avoids interference and back-reflection
- System mount Ø 19.5 mm
- Adjustable using Schäfter+Kirchhoff Polarization Analyzer series [SK010PA](#).

## TECHNICAL DATA

48WP-2-780-1-767, dichroic wave plate, multiple-order

|                               |                  |
|-------------------------------|------------------|
| Order Code                    | 48WP-2-780-1-767 |
| Center wavelength $\lambda/2$ | 780 nm           |
| Center wavelength $\lambda/1$ | 767 nm           |
| Order                         | multiple-order   |
| AR coating                    | yes              |
| Material                      | Quartz           |
| Clear aperture                | 5 mm             |
| System mount                  | Ø 19.5 mm        |

|   |               |
|---|---------------|
| Adjustment range  | 360°          |
| Inclined rotary axis  | 2°            |
| Housing material  | Nickel silver |
| Weight  | 46 g          |
| Dimensions (for a complete dimensional drawing please refer to the downloads section) |               |

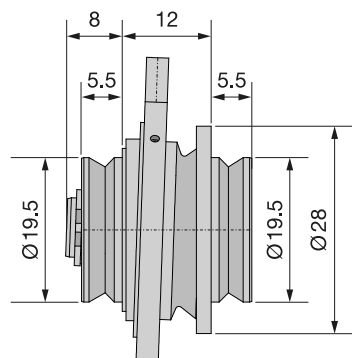

## DOWNLOADS



[980210090404.pdf \(Dimensional drawing\)](#)

## ACCESSORIES

### POLARIZATION ANALYZER SK010PA

Measurement tool for coupling into polarization-maintaining fiber cables

## RELATED PRODUCTS

### HALF-WAVE PLATE 48WP-2 (ZERO-ORDER)

The half-wave plate rotates the polarization direction of a linearly polarized input beam

### HALF-WAVE PLATE 48WP-2 (LOW-ORDER)

The half-wave plate rotates the polarization direction of a linearly polarized input beam

### FIBER PORT CLUSTER 2 → X DICHROIC

Compact, rugged and highly efficient opto-mechanical unit for splitting/combining multiple ports

## MULTICUBE SYSTEM

Multicube-Components and Systems

This is a printout of the page <https://sukhamburg.com/products/details/48WP-2-780-1-767> from 5/6/2024

## CONTACT

For more information please contact:

Schäfter + Kirchhoff GmbH

Kieler Str. 212

22525 Hamburg

Germany

Tel: +49 40 85 39 97-0

Fax: +49 40 85 39 97-79

[info@sukhamburg.de](mailto:info@sukhamburg.de)

[www.sukhamburg.com](http://www.sukhamburg.com)

## LEGAL NOTICE

**Copyright 2020 Schäfter+Kirchhoff GmbH. All rights reserved.**

Text, image, graphic, sound, video and animation files and their arrangement on Schäfter+Kirchhoff GmbH webpages are protected by copyright and other protective laws. The content may not be copied for commercial use or reproduced, modified or used on other websites. [\[more\]](#)