

## 25AM-0-FC

Bulkhead fiber adapter FC PC to Ø 25 mm with Tilt alignment



### FEATURES

Bulkhead fiber adapter

- Receptacle type FC PC
- Outer diameter Ø 25 mm
- Paraxial coupling axis
- TILT alignment

- With integrated TILT adjustment



## TECHNICAL DATA

25AM-0-FC

Order Code	25AM-0-FC	
Adapter	FC PC	Outer diameter
		Ø 25 mm
Paraxial coupling axis		
TILT alignment		± 1.5°
Material	Nickel silver	
Weight	45 g	

Dimensions (for a complete dimensional drawing please refer to the downloads section)

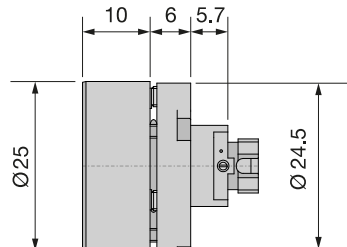

## DOWNLOADS



[970920520621.pdf \(Dimensional drawing\)](#)

## ACCESSORIES

<b>9D-12</b>	Screwdriver WS 1.2
<b>50HD-15</b>	Hex key WS 1.5

## RELATED PRODUCTS

<b>BULKHEAD FIBER ADAPTERS</b>	Fiber Adapters without Optics
<b>ADAPTERS FOR FIBER OPTICS</b>	Adapters to use with fiber collimators and with the multicube™ system.
<b>FIBER PATCH CABLES</b>	Single-mode and polarization-maintaining fiber cables as well as multi-mode fiber cables

This is a printout of the page <https://sukhamburg.com/products/details/25AM-0-FC> from 4/25/2024

## CONTACT

For more information please contact:

**Schäfter + Kirchhoff GmbH**

**Kieler Str. 212**

**22525 Hamburg**

**Germany**

**Tel: +49 40 85 39 97-0**

**Fax: +49 40 85 39 97-79**

**[info@sukhamburg.de](mailto:info@sukhamburg.de)**

**[www.sukhamburg.com](http://www.sukhamburg.com)**

## LEGAL NOTICE

**Copyright 2020 Schäfter+Kirchhoff GmbH. All rights reserved.**

Text, image, graphic, sound, video and animation files and their arrangement on Schäfter+Kirchhoff GmbH webpages are protected by copyright and other protective laws. The content may not be copied for commercial use or reproduced, modified or used on other websites. [\[more\]](#)