

19.5AC19.5

Adapter with system mount Ø 19.5 mm on both ends



FEATURES

Adapter for the Schäfter+Kirchhoff multicube™ system.

Both ends system mount Ø 19.5 mm

TECHNICAL DATA

19.5AC19.5

Order Code		19.5AC19.5
Adapter	System mount	System mount
	Ø 19.5 mm	Ø 19.5 mm
	Steel ring	Steel ring
Clear aperture	Ø 14 mm	
Material	Nickel silver / steel	
Weight	13 g	

Dimensions (for a complete dimensional drawing please refer to the downloads section)

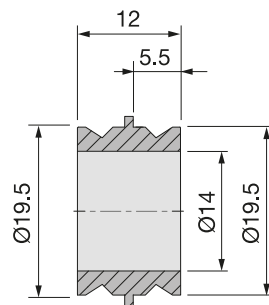

DOWNLOADS



[930730070200.pdf \(Dimensional drawing\).](#)

RELATED PRODUCTS

ADAPTERS FOR FIBER OPTICS

Adapters to use with fiber collimators and with the multicube™ system.

ADAPTERS FOR SYSTEM MOUNT Ø 19.5MM

for incorporation into the multicube™ system

ATTACHMENT OPTICS SERIES 13

to attach in the front of collimators with system mount Ø19.5 mm

This is a printout of the page https://sukhamburg.com/products/details/19_5AC19_5 from 5/7/2024

CONTACT

For more information please contact:

Schäfter + Kirchhoff GmbH

Kieler Str. 212

22525 Hamburg

Germany

Tel: +49 40 85 39 97-0

Fax: +49 40 85 39 97-79

info@sukhamburg.de

www.sukhamburg.com

LEGAL NOTICE

Copyright 2020 Schäfter+Kirchhoff GmbH. All rights reserved.

Text, image, graphic, sound, video and animation files and their arrangement on Schäfter+Kirchhoff GmbH webpages are protected by copyright and other protective laws. The content may not be copied for commercial use or reproduced, modified or used on other websites. [\[more\]](#)