

## 13PF-P-1300-S

Dichroic polarization filter (short version)



### FEATURES

Polarization filter with system mount Ø 19.5 mm for attaching to [60FC-L](#) and [60FC-T](#) Fiber Collimators with outer diameter Ø 25 mm. This filter transmits only the linear polarized component of the radiation.

- Dichroic polarization filter. The filter is laminated to a glass substrate with an 0.5° inclined mounting in order to avoid direct back-reflections
- Polarization extinction ratio 10.000:1
- Surface deviation <  $\lambda/4$
- Clear aperture: Ø 12 mm
- System mount: Ø 19.5 mm
- AR Coating: 1280 - 1500 nm
- Short Version without front fitting

## TECHNICAL DATA

13PF-P-1300-S

Order Code	13PF-P-1300-S
Type	Dichroic polarization filter
Wavelengths range	1250 - 1500 nm
Extinction	10.000:1
Transmission	> 96 - 98 %
AR Coating	1250 - 1500 nm (residual reflectivity < 1.5 %)
Surface deviation	< $\lambda/4$
Clear aperture	12 mm
Inclined mount	0.5°
System mount	Ø 19.5 mm

Front fitting

-

Housing material

Nickel silver

Weight

42 g

Dimensions (for a complete dimensional drawing please refer to the downloads section)

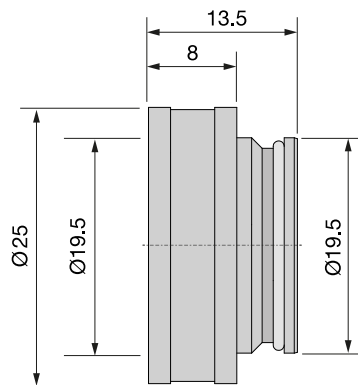

## DOWNLOADS

[930730090600.pdf \(Dimensional drawing\).](#)

## ACCESSORIES

**POLARIZATION  
ANALYZER SK010PA**Measurement tool for coupling into polarization-  
maintaining fiber cables

## RELATED PRODUCTS

**POLARIZATION FILTERS  
5PF**

for attaching to 60FC Fiber Collimators

This is a printout of the page <https://sukhamburg.com/products/details/13PF-P-1300-S> from 5/6/2024

## CONTACT

For more information please contact:

Schäfter + Kirchhoff GmbH

Kieler Str. 212

22525 Hamburg

Germany

Tel: +49 40 85 39 97-0

Fax: +49 40 85 39 97-79

[info@sukhamburg.de](mailto:info@sukhamburg.de)

[www.sukhamburg.com](http://www.sukhamburg.com)

## LEGAL NOTICE

**Copyright 2020 Schäfter+Kirchhoff GmbH. All rights reserved.**

Text, image, graphic, sound, video and animation files and their arrangement on Schäfter+Kirchhoff GmbH webpages are protected by copyright and other protective laws. The content may not be copied for commercial use or reproduced, modified or used on other websites. [\[more\]](#)