

## 13BL0-12

Iris diaphragm for fiber collimators with diameter  $\varnothing$  25/28 mm. Can be closed completely.



### FEATURES

Iris diaphragm with an variable aperture for fiber collimators series 60FC-L/T/Q with an outer diameter  $\varnothing$  25 mm. Unlike the iris diaphragm type 13BL1-13, this can be closed completely.

- System mount  $\varnothing$  19.5 mm
- Can be closed completely
- Max. aperture  $\varnothing$  13 mm

**Please note:** In case of use with a single-mode / PM-fiber, the Gaussian beam from the fiber collimator is truncated by the iris diaphragm or by the pinhole

## DESCRIPTION

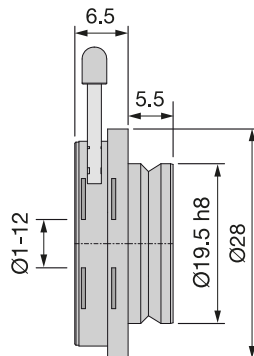

## TECHNICAL DATA

13BL0-12

Dimensions (for a complete dimensional drawing please refer to the downloads section)

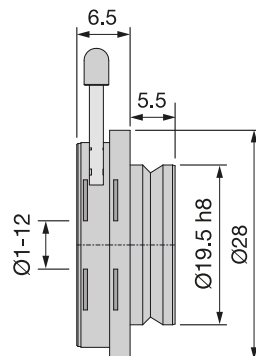

## DOWNLOADS



[930730080200.pdf \(Dimensional drawing\)](#)

## RELATED PRODUCTS

### IRIS DIAPHRAGMS BL

for collimators

### ATTACHMENT OPTICS SERIES 13

to attach in the front of collimators with system mount  
Ø19.5 mm

### FIBER COLLIMATORS SINGLE-MODE/PM

Fiber Collimators for collimating light exiting a single-  
mode or polarization-maintaining fiber cable

This is a printout of the page <https://sukhamburg.com/products/details/13BL0-12> from 3/28/2024

## CONTACT

For more information please contact:

**Schäfter + Kirchhoff GmbH**

**Kieler Str. 212**

**22525 Hamburg**

**Germany**

**Tel: +49 40 85 39 97-0**

**Fax: +49 40 85 39 97-79**

**[info@sukhamburg.de](mailto:info@sukhamburg.de)**

**[www.sukhamburg.com](http://www.sukhamburg.com)**

## LEGAL NOTICE

**Copyright 2020 Schäfter+Kirchhoff GmbH. All rights reserved.**

Text, image, graphic, sound, video and animation files and their arrangement on Schäfter+Kirchhoff GmbH webpages are protected by copyright and other protective laws. The content may not be copied for commercial use or reproduced, modified or used on other websites. [\[more\]](#)