

Laser power adjustment, turn clock wise to increase using screw-driver size 1.6mm 9D-16 ②

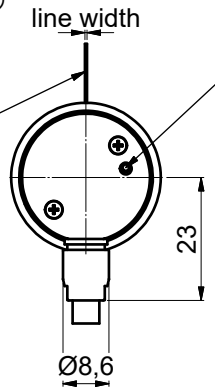

Orientation of laser line with respect to housing

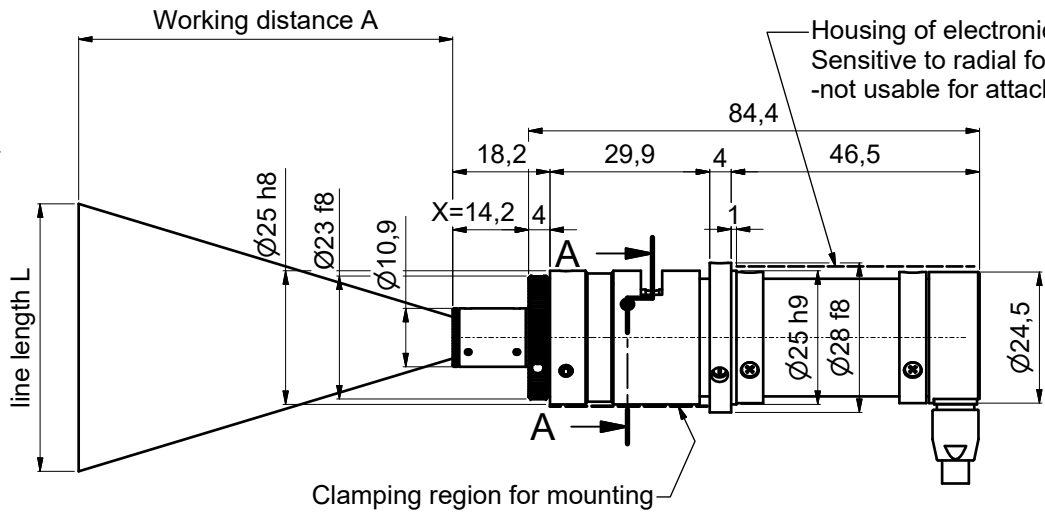

adjustment of collimation optics by rotation the optics using hex-key 50HD-15 ①

Housing of electronics. Sensitive to radial force -not usable for attachment!

A-A

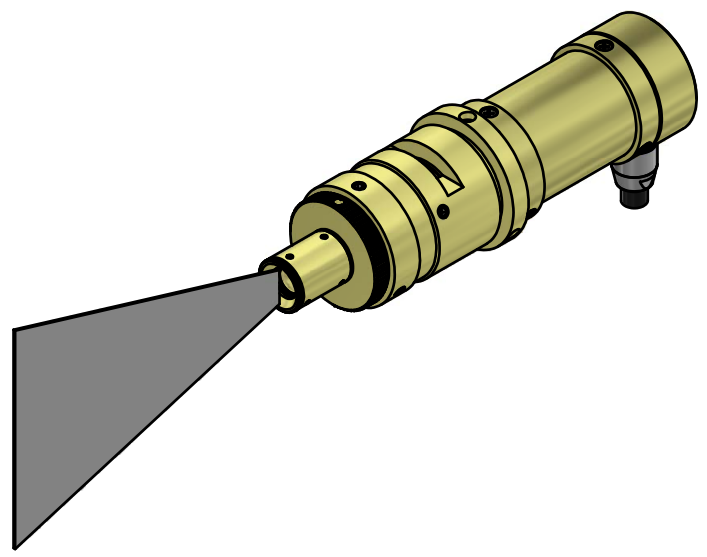
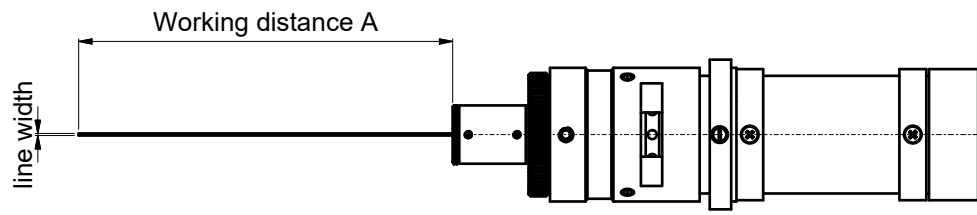
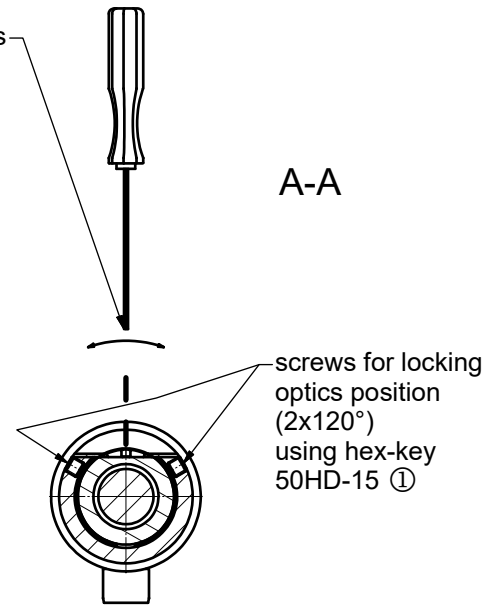

Tools for assembly and adjustment

hex-key size 1.5mm 50HD-15
screw driver size 1.6mm 9D-16

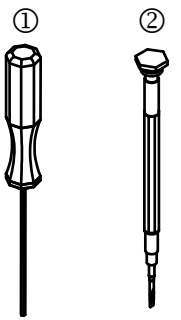

For information only
Not for manufacturing purposes

Dimensions DIN EN ISO 14405		Scale: 1:1		Date 08.06.2020		Name Trapp	
				editor		LNC-5LP+56CR X = 14.2	
				exam.		Laser Diode Modules with Low Coherence	
				free		Customer Drawing	
				Schäfter+Kirchhoff OPTICS, METROLOGY, AND PHOTONICS		9304-1200-0133	
				File: 930412000133.idw		Model: 930412000133.iam	
						Size: A3	
						Page: 1	