

Laser power adjustment, turn clock wise to increase

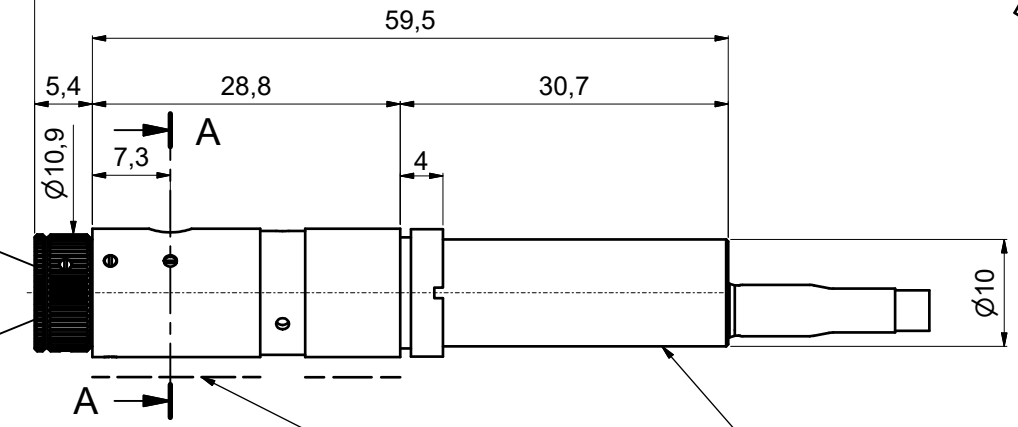
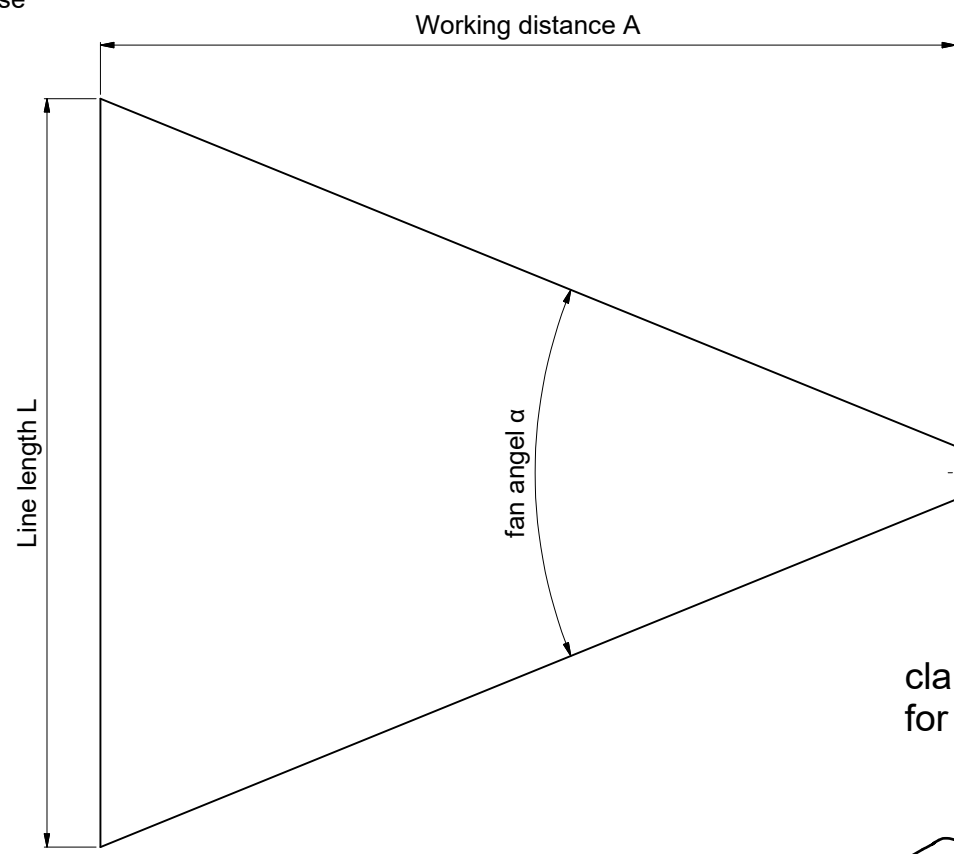

Housing of electronics. Sensitive to radial force -not usable for attachment!

clamp screws for locking optics position (2x120°) using screw-driver size 1.2mm 9D-12 ①

A-A

adjustment of focus setting using eccentric-key 60EX-4 ②

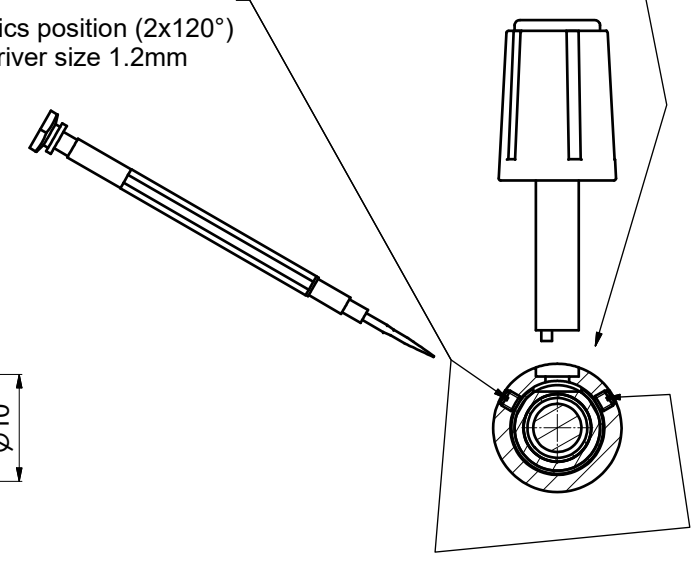

clamping region for mounting

line width B

Tools for assembly and adjustment

screw driver size 1.2mm 9D-12 ①

eccentric-key 60EX-4 ②

**! Don't touch any other screws !**

		Allgemeintoleranz ISO 2768 - f		Maßstab: 2:1	
		5LM + 25CM + 54			
		Datum Name		5LM + 25CM + 54	
		Bearb. 13.07.2017 A.Trapp		Laser Microline Generator	
		Gepr.			
		Norm			
		Schäfter&Kirchhoff OPTO-SENSORIK UND MESSTECHNIK		9211-2000-0624	
		Date: 921120000624.idw		Blatt A2	
		Zust. Änderungen Datum Name		Blatt: 1	
		Date: 921120000624.idw		Model: 921120000624.iam	