

Thrust and tension screw (3x120°)
for tilt adjustment
with hex key wrench size 1.5mm
50HD-15 ①

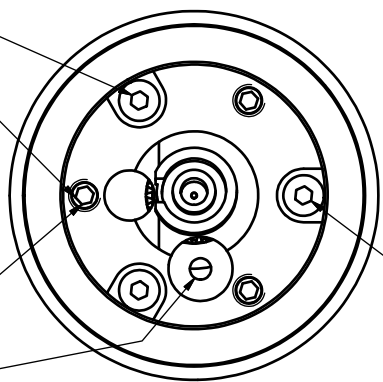

Rotation of the quarter wave plate
with adjustment key ④

Thrust screw M3 max.torque 50Ncm
Tension screw M2 max.torque 40Ncm

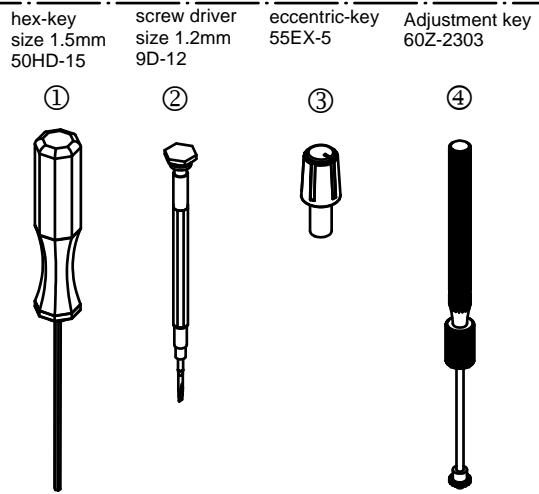

! Pin screw for additional locking of the fiber ferrule:
- before pulling the FC-connector:
unlock the pin screw.
- before inserting the FC-connector:
make sure the ferrule receptacle is not blocked
by the pin screw !

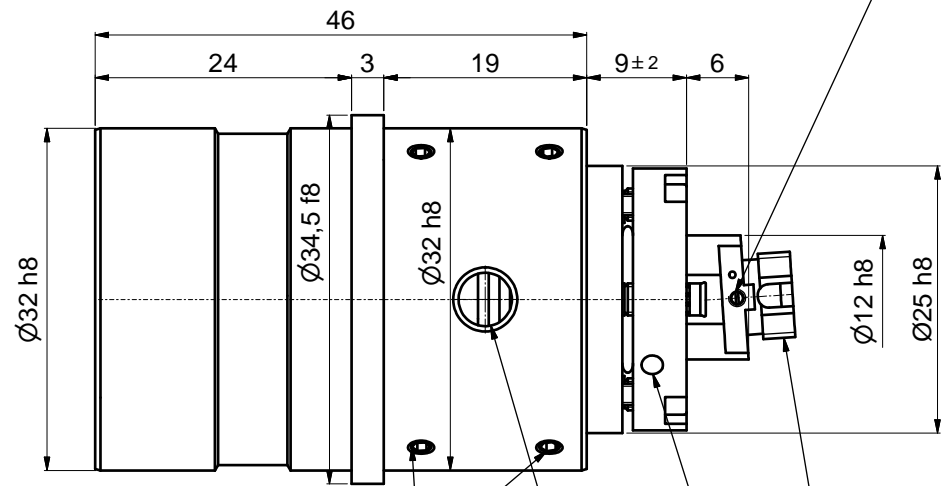

clamp screws for locking optics position (3x120°)
using hex-key size 1.5mm
50HD-15 ①

adjustment of focus setting
using eccentric-key 55EX-5 ③

Fiber receptacle
type FC-APC
(wide key)

Stop screw (2x120°) for lock/unlock
of the rotation of the
quarter wave plate
with screwdriver 1.2mm 9D-12 ②

! Don't touch any other screws !

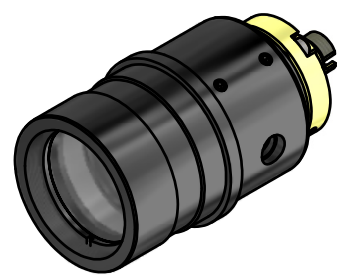

| | | |
|---|------------|------------------------------|
| Allgemeintoleranz ISO 2768 - f | | Maßstab: 2:1 |
| 60FC-Q-4-M50L-xx | | |
| Datum 09.03.2015 | | Name Tp |
| Gepr. | | |
| Norm | | |
| Schäfter&Kirchhoff OPTO-SENSORIK UND MESSTECHNIK OPTIK-ENTWICKLUNG/ELEKTRONIK/SORTIMENTE/SOFTWARE | | Fiber collimator f'50 |
| 9802-4186-8600 | | Fiber receptacle type FC-APC |
| Blatt A3 | | |
| Blatt 2 | | |
| Zust. | Änderungen | Datum |
| Name | | Datei: 980241868600.idw |
| Model: | | 980241868600.iam |